

IMPORTANT SAFETY INFORMATION

READ AND FOLLOW ALL SAFETY INSTRUCTIONS

**FOR FIELD ASSISTANCE PLEASE CALL
+1-213-255-2060 #4**

- Before wiring to power supply and during servicing or relamping, turn off power at fuse or circuit breaker.
- All servicing or relamping must be performed by qualified service personnel.
- Product must be grounded to avoid potential electric shock or other potential hazard.
- Product must be installed at locations and heights, in a manner consistent with its intended use, and in compliance with electrical code and local codes.

SAVE THESE INSTRUCTIONS FOR FUTURE REFERENCE

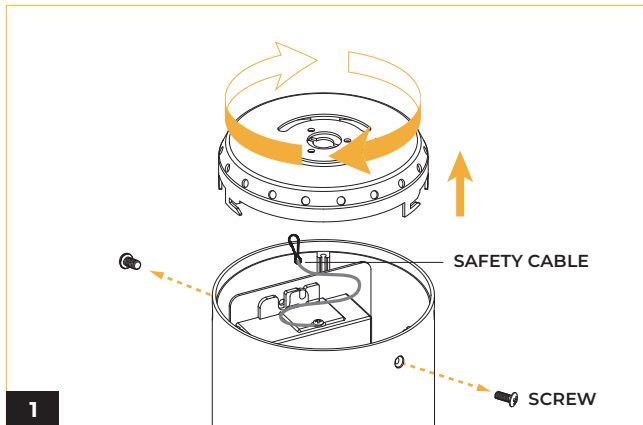

Loosen two screws on the side of the fixture. Twist and lift up the lid from the cylinder. Unhook the safety wire from the cylinder to detach the lid.

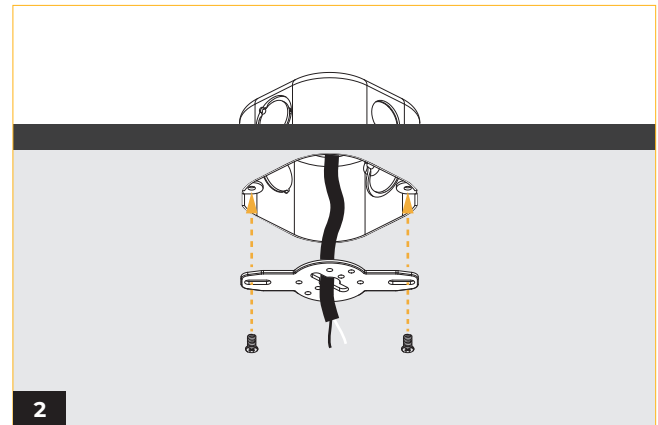

Secure the crossbar to the junction box (supplied by others), using two Phillips screws.

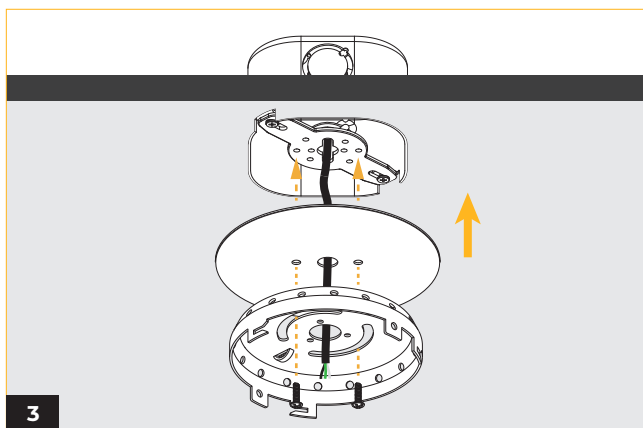

Use two Phillips screws to secure the canopy to the crossbar, going through the cover plate.

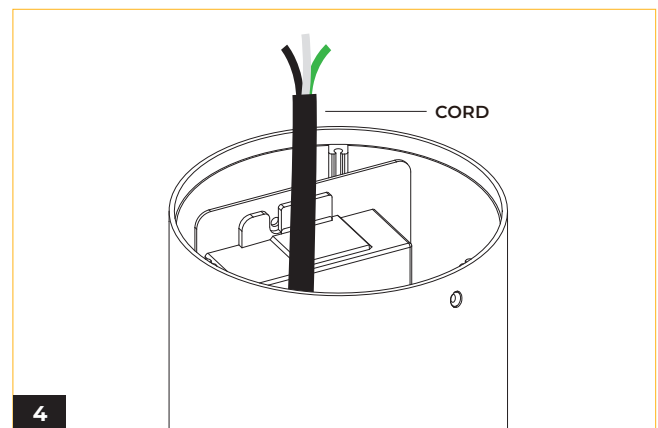

Make electrical connections between the junction box and the fixture with UL listed connectors or wire nuts (supplied by others). Refer to the wiring diagram below.

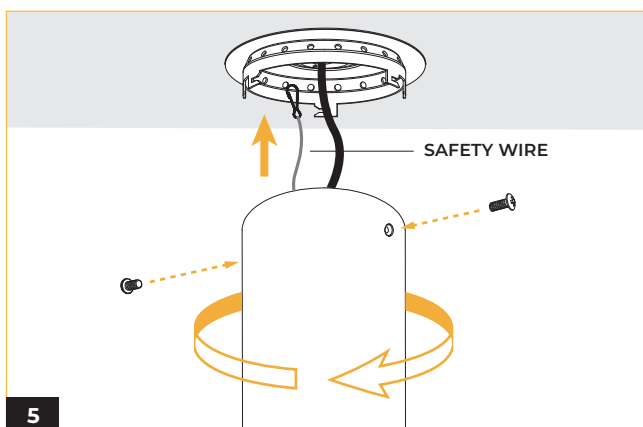

Attach the safety wires to the fixture lid. Secure the fixture and secure it using two Allen screws.

WIRING DIAGRAM

SPV 0-10V

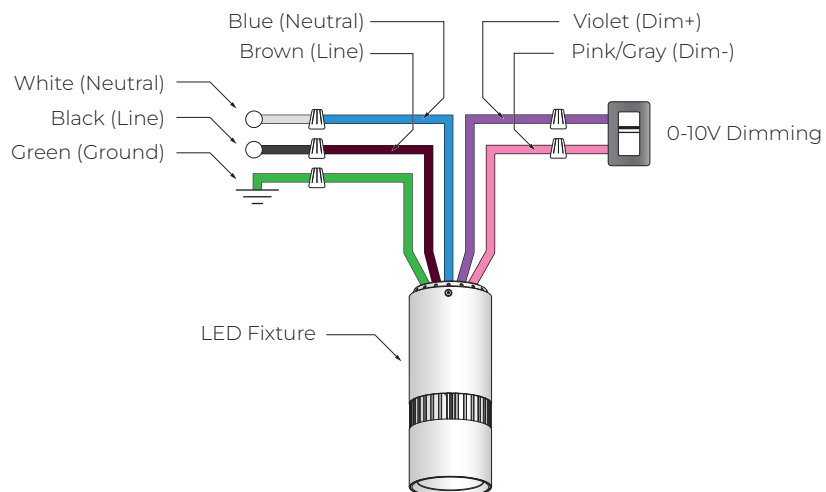

TRC

