

IMPORTANT SAFETY INFORMATION READ AND FOLLOW ALL SAFETY INSTRUCTIONS

**FOR FIELD ASSISTANCE PLEASE CALL
+1-213-255-2060 #4**

- Before wiring to power supply and during servicing or relamping, turn off power at fuse or circuit breaker.
- All servicing or relamping must be performed by qualified service personnel.
- Product must be grounded to avoid potential electric shock or other potential hazard.
- Product must be installed at locations and heights, in a manner consistent with its intended use, and in compliance with electrical code and local codes.

SAVE THESE INSTRUCTIONS FOR FUTURE REFERENCE

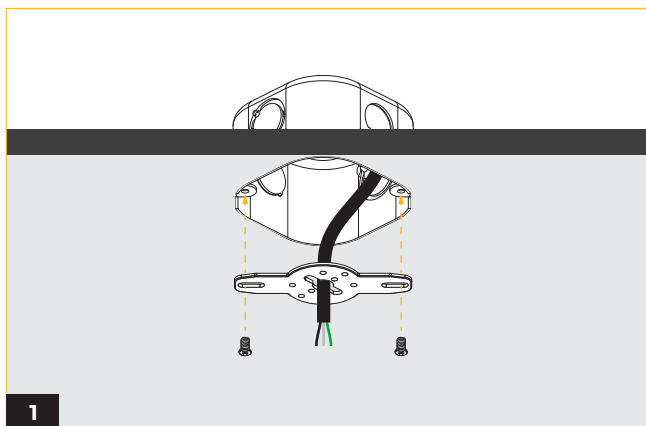

1

Secure the crossbar to junction box (by others), using two phillips screws.

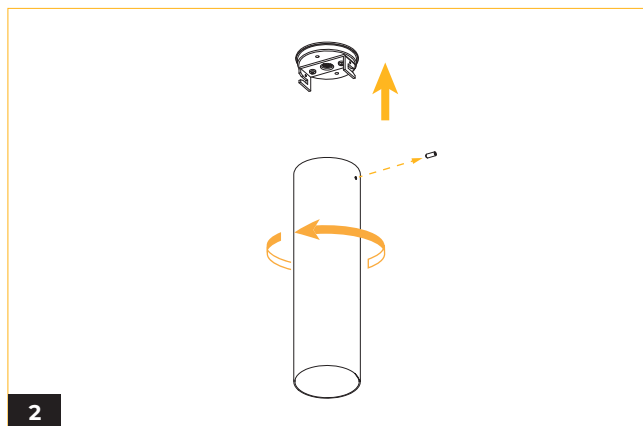

2

Remove top cover of luminaire by removing the hex screw located on the side of the luminaire.

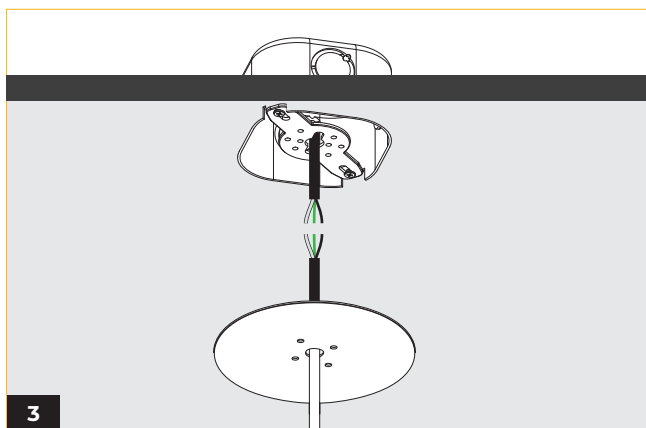

3

Make electrical connections between crossbar and mounting plate. Refer to the wiring diagram for more detailed instructions.

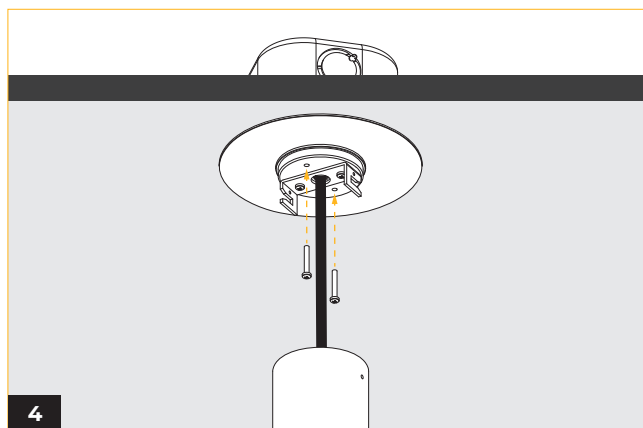

4

Secure top cover of luminaire to canopy plate using 2 phillips screws

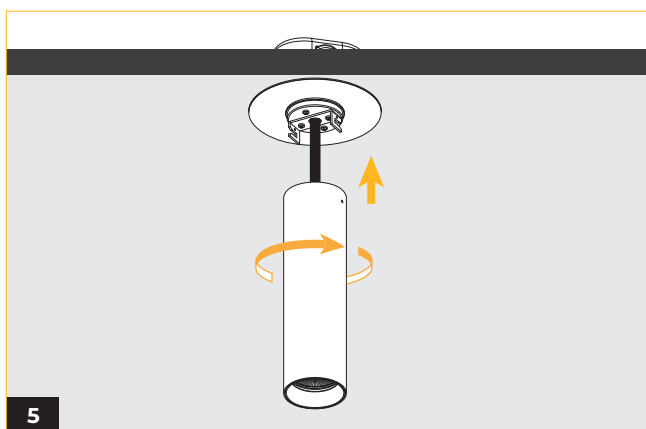

5

Secure the luminaire onto the top cover by hoisting level and rotating clockwise.

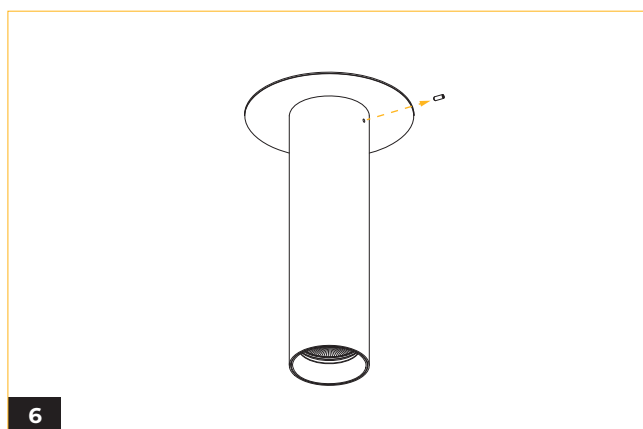

6

Secure fixture with hex screw.

WIRING DIAGRAM

0-10V / Superior 0-10V

*Not to Scale

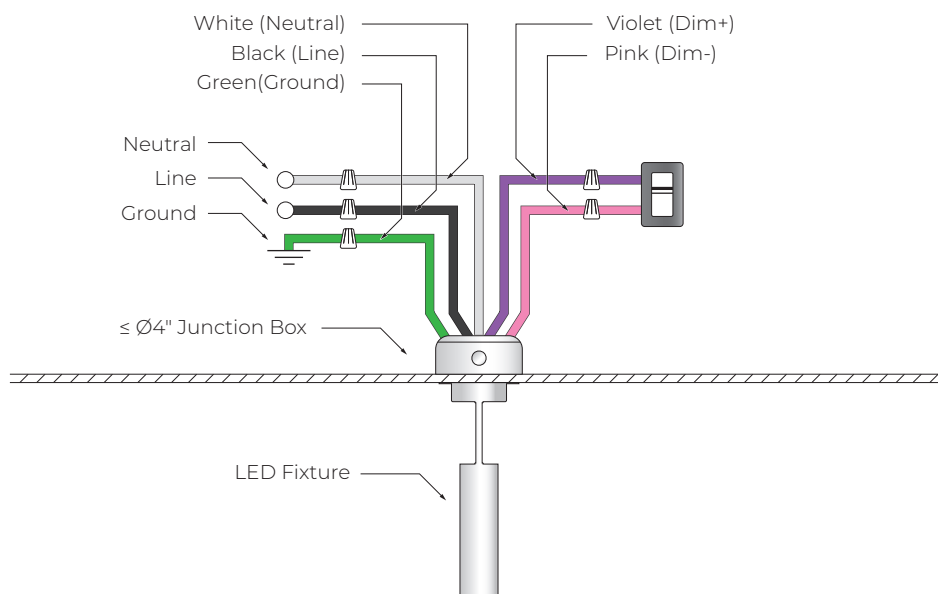

TRC

*Not to Scale

