

IMPORTANT SAFETY INFORMATION READ AND FOLLOW ALL SAFETY INSTRUCTIONS

**FOR FIELD ASSISTANCE PLEASE CALL
+1-213-255-2060 #4**

- Before wiring to power supply and during servicing or relamping, turn off power at fuse or circuit breaker.
- All servicing or relamping must be performed by qualified service personnel.
- Product must be grounded to avoid potential electric shock or other potential hazard.
- Product must be installed at locations and heights, in a manner consistent with its intended use, and in compliance with electrical code and local codes.

SAVE THESE INSTRUCTIONS FOR FUTURE REFERENCE

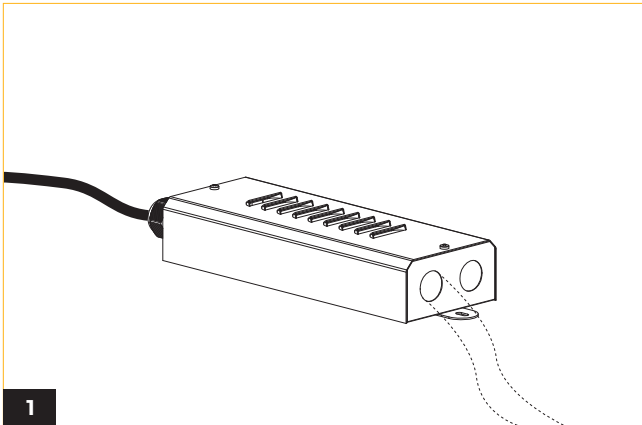

1 Remove knockout for power connection.

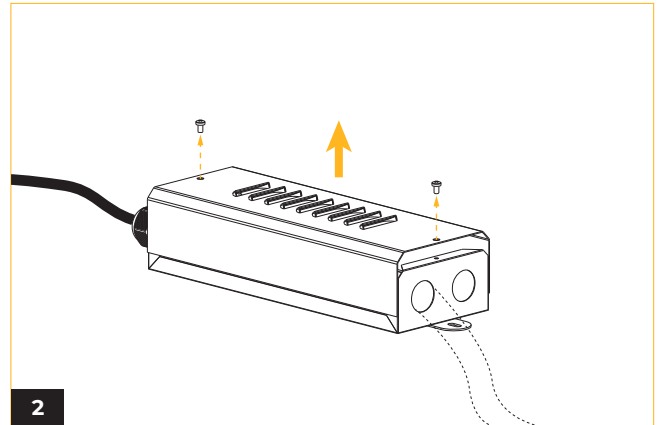

2 Remove powerbox lid to make electrical connections (Refer to wiring diagram).

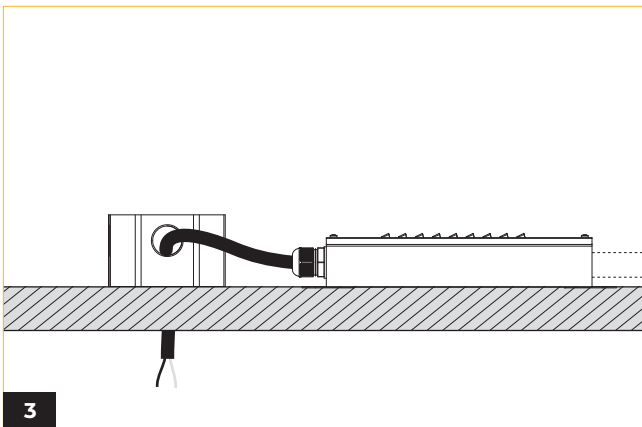

3 Thread the DC cables from powerbox through the junction box.

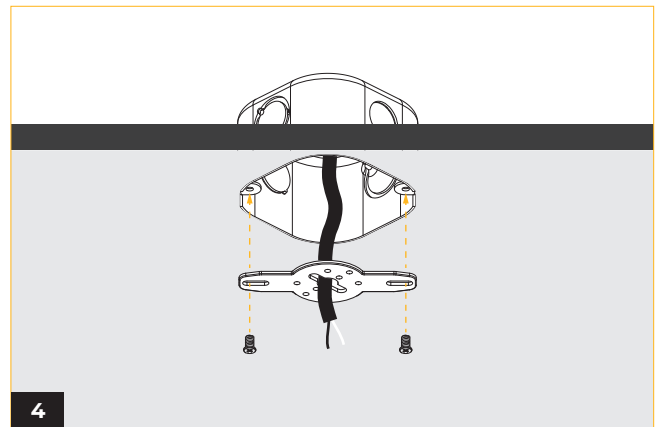

4 Secure the crossbar to junction box (by others), using two phillips screws.

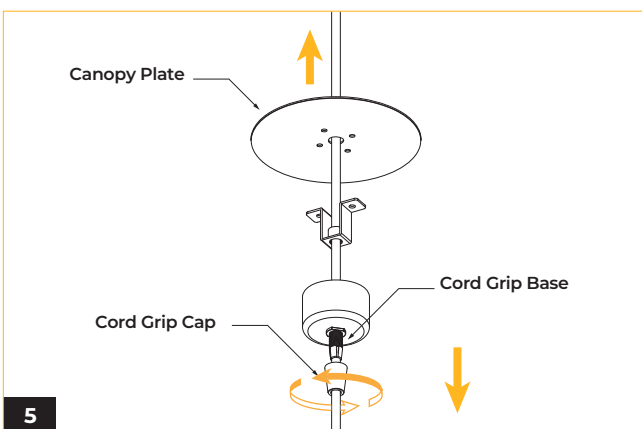

5 Remove the base and cap of the cord grip, adjust mounting length accordingly. Once adjusted to a desired height, slip cord through canopy plate.

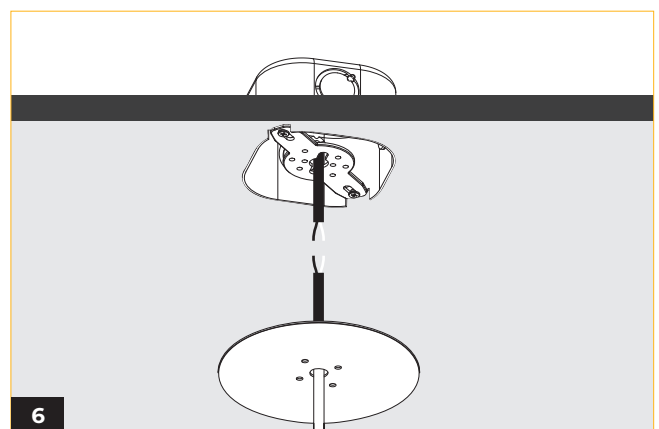

6 Make electrical connections between crossbar and mounting plate. Refer to the wiring diagram for more detailed instructions.

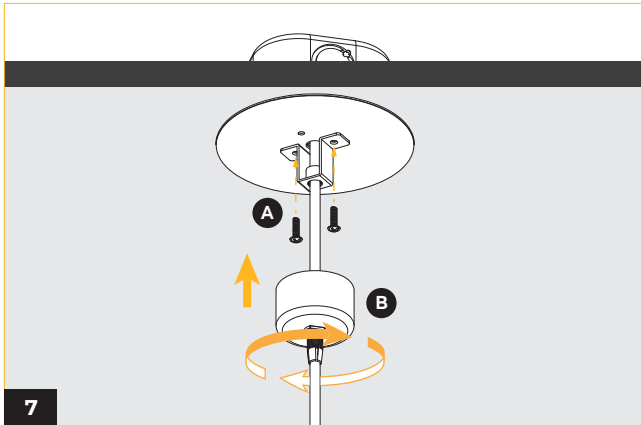

(A) Fasten canopy plate in place using 2 phillips screws.

(B) Cover the canopy plate with the canopy cover, and secure it by screwing in the cord grip base.

** Caution when applying force during the installation of the cord grip base to avoid any potential damage or breakage.*

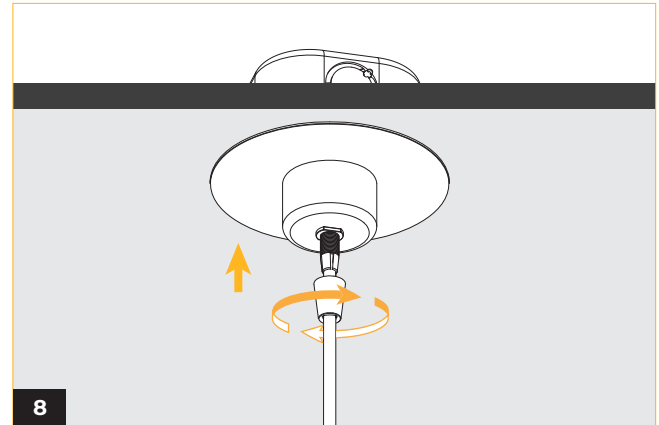

Screw in the cord grip cap to finish the installation.

WIRING DIAGRAM

0-10V / Superior 0-10V

*Not to scale

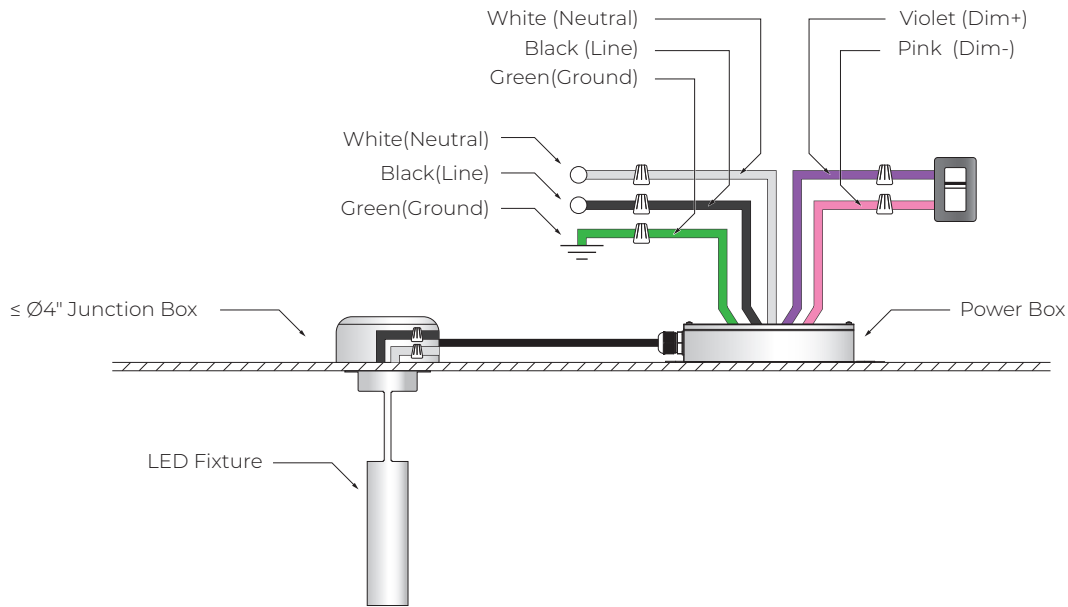

TRC

*Not to scale

