

## Dext 2.0 - Standard

METEOR



High Lumen, High Bay Luminaire with 16,500 - 34,800 lumen output, perfectly suited for 400/500W Metal Halide replacements.

|          |  |      |  |
|----------|--|------|--|
| Quantity |  | Type |  |
| Project  |  | Note |  |

**Electrical System**

- Downlight
- 17400 lm (150W)
- 23200 lm (200W)
- 34800 lm (280W)
- Uplight
- 2320 lm (20W)
- Power Input: Universal (120-277V)
- Operating Temperature: -40°F~104°F
- Surge Protection: 4KV

**LED Technology**

- 3000K, 4000K, 5000K
- 80 CRI
- Beam Angle: 50°, 100°
- Rated Life > 60,000 Hours (L70)

**Advanced Dimming**

(Proprietary VX Driver is incorporated to all dimming options for video flicker-free lighting)

- Standard 0-10V: dims to 10%

**Housing**

- Diameter: Ø14.5" (368mm)
- Height: 10.25" (260mm)
- Material: High Pressure Die-Cast Aluminum, PC lens
- Weight: 17.64lbs

**Mounting**

- Stem 2ft or 4ft; 45° Swivel Canopy Included
- Adjustable Aircraft Cable 10ft
- Bracket

**Warranty**

- 5 years limited warranty

**Listing**

- ETL Wet Location Listed



Not all Dext 2.0 Series are DLC qualified.  
For all qualified products.  
Please visit: [www.designlights.org/qpl](http://www.designlights.org/qpl)

## Dext 2.0 - Standard



## How To Specify:

Ordering Example: DS2-170-508-UNV-STV-100-WHT-ST2

| Model                  | Wattage  | CCT / CRI   | Voltage             | Dimming   |
|------------------------|--|---|---------------------|---|
| DS2                    |  |   | UNV                 | STV   |
| DS2<br>Dext 2.0 Series | <b>150</b> 150W<br><b>170*</b> 170W<br><b>200</b> 200W<br><b>220*</b> 220W<br><b>280</b> 280W<br><br>* Includes 20W Uplight Module | <b>308</b> 3000K / CRI 80<br><b>408</b> 4000K / CRI 80<br><b>508</b> 5000K / CRI 80 | <b>UNV</b> 120-277V | <b>NOD</b> Non-Dimming<br><b>STV</b> Standard 0-10V dims to 10% |

| Beam Angle  | Finish                               | Mounting  | Accessories   |
|---|--------------------------------------|---|---|
| <b>50</b> 50°<br><b>100</b> 100°<br><br>*Beam angle options are only available for Downlight.<br>*Uplight beam angle fixed at 100°. | <b>BLK</b> Black<br><b>WHT</b> White | <b>ST2</b> Stem 2ft<br><b>ST4</b> Stem 4ft<br><b>AD10</b> Adjustable Cable 10ft<br><b>BRK</b> Bracket | <b>SPD</b> <sup>1</sup> Surge Protector<br><b>WG</b> <sup>2</sup> Wire Guard<br><br><sup>1</sup> Surge protector for up to 10KV. Applicable for unstable mains or facilities using high power machinery.<br><sup>2</sup> Please factor in change in lumen output of -14%. |

## Delivered Lumens\*

## Downlight

| Wattage<br>CCT | Beam Angle: 50° |           |           |
|----------------|-----------------|-----------|-----------|
|                | 150W            | 200W      | 280W      |
| 5000K          | 17,400 lm       | 23,200 lm | 34,800 lm |
| 4000K          | 16,950 lm       | 22,600 lm | 33,900 lm |
| 3000K          | 16,500 lm       | 22,000 lm | 33,000 lm |

\*Tolerance±8%

DesignLights Consortium™ Qualified Luminaires:  
 DLC QPL Model Number : DS2-220-507, DS2-220-407  
 Not all product variations listed on this page are DLC qualified.  
 To ensure that a specific model is qualified, visit  
[www.designlights.org/search](http://www.designlights.org/search).

## Uplight

| Wattage<br>CCT | Beam Angle: 100° |
|----------------|------------------|
|                | 20W              |
| 5000K          | 2320 lm          |
| 4000K          | 2260 lm          |
| 3000K          | 2200 lm          |

## Current Consumption

| Wattage<br>Volt | 120V  | 277V  |
|-----------------|-------|-------|
|                 |       |       |
| 150W            | 1.52A | 0.66A |
| 170W            | 1.73A | 0.75A |
| 200W            | 2.03A | 0.88A |
| 220W            | 2.23A | 0.97A |
| 280W            | 3.05A | 1.32A |

# Dext 2.0 - Standard

## Dimensions

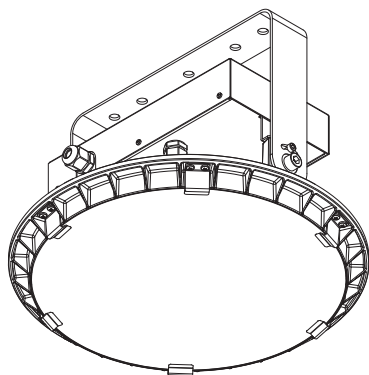
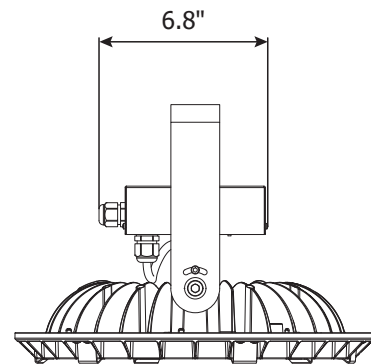
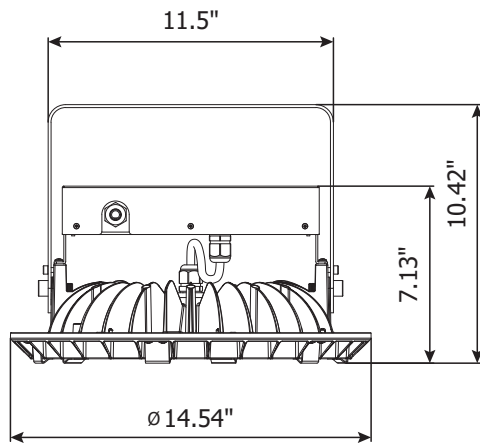
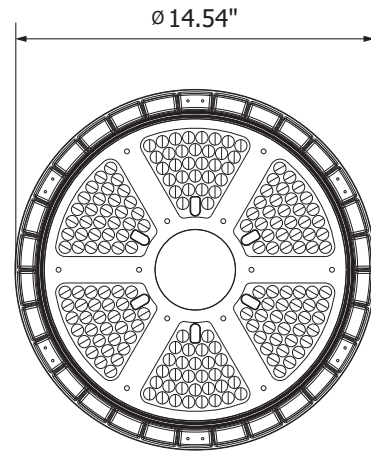
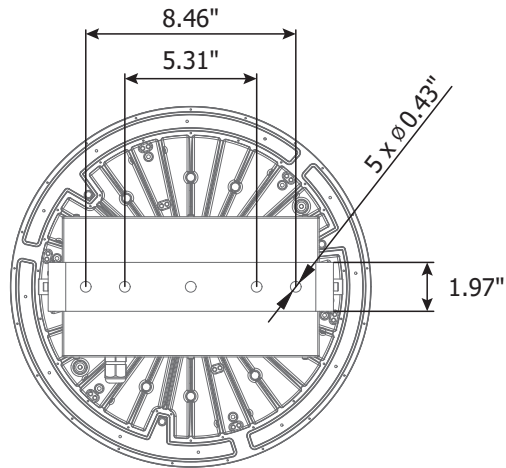

# Dext 2.0 -

## Mounting Options

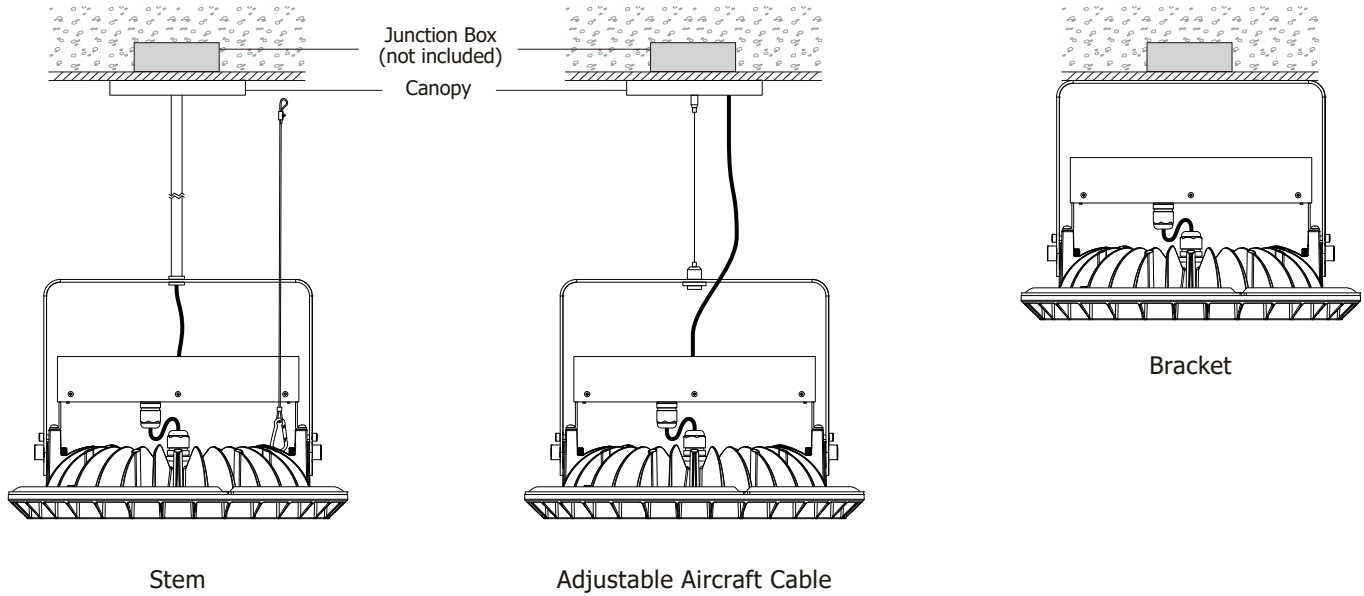

## Accessory

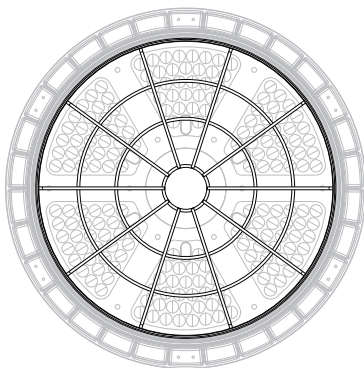

Wire Guard